



CANADIAN AGRICULTURAL ECONOMICS SOCIETY/
SOCIÉTÉ CANADIENNE D'AGROÉCONOMIE

PROGRAM

2024 CAES Annual Meeting Congrès annuel SCAÉ 2024

Fort Garry Hotel

Winnipeg

July 7-9

TABLE OF CONTENTS TABLES DE MATIÈRES

WELCOME! BIENVENUE !.....	1
GENERAL INFORMATION INFORMATION GÉNÉRALES	1
SCHEDULE HORAIRE	3
DETAILED PROGRAM PROGRAMME DÉTAILLÉ	4
SUNDAY DIMANCHE	4
MONDAY LUNDI.....	4
TUESDAY MARDI.....	11
MADHU KHANNA BIOGRAPHY BIOGRAPHIE	16
2025 ANNUAL MEETING CONGRÈS ANNUEL 2025	16
FLOOR PLANS PLANS D'ÉTAGE	17

WELCOME! | BIENVENUE !



Welcome to the 2024 CAES Annual Meeting in Winnipeg! This year we have an excellent slate of events, speakers, symposia, and paper sessions. On Sunday afternoon, our presidential address will be delivered by Yu Na Lee, followed by a welcome reception in the beautiful Grand Ballroom of the historic Fort Garry Hotel in downtown Winnipeg. Our first full conference day is packed with events; including the fellow's address—delivered this year by Ellen Goddard, our annual business meeting (after the days' concurrent sessions have concluded), and the CAES awards dinner. I'm especially excited for this year's keynote speaker, Madhu Khanna, the ACES Distinguished Professor in Environmental Economics at the University of Illinois (for more information on Dr. Khanna, please refer to the bio published on page 16 of this program). I hope that you enjoy the program we've put together on behalf of our members, and I look forward to seeing you in Winnipeg!

GENERAL INFORMATION | INFORMATION GÉNÉRALES

Registration:

Grand Ballroom Foyer

- Sunday, July 7, 4:30 PM - 8:30 PM
- Monday, July 8, 8:00 AM - 5:00 PM
- Tuesday, July 9, 8:00 AM - 12:00 PM

Name badges

Pick up at the registration table during hours shown above. Badges (registrants and guests) must be worn to access all events and sessions.

Awards banquet

The banquet is included as part of your registration fee. Attendees and guests must wear their name badges to enter. The awards banquet will take place in the Grand Ballroom.

Welcome reception

The welcome reception is included as part of your registration fee. Attendees and guests must wear their name badges to enter. The

Inscription:

Grand Foyer du Grand Ballroom

- Dimanche 7 juillet : 16h30 - 20h30
- Lundi 8 juillet : 8h00 - 17h00
- Mardi 9 juillet : 8h00 - 12h00

Badges nominatifs

Récupérez votre badge à la table d'inscription pendant les heures indiquées ci-dessus. Les badges (inscrits et invités) doivent être portés pour accéder à tous les événements et sessions.

Banquet de remise des prix

Le banquet est inclus dans vos frais d'inscription. Les participants et les invités doivent porter leur badge nominatif pour entrer. Le banquet de remise des prix aura lieu dans le Grand Ballroom.

Réception de bienvenue

La réception de bienvenue est incluse dans vos frais d'inscription. Les participants et les invités doivent porter leur badge nominatif



reception will take place in the Grand Ballroom.

Breakfast and lunch

Breakfast and lunch on Monday and Tuesday are included in the registration fee. You must wear your name badge to enter. Breakfast and lunch will be served in the Grand Ballroom.

Information for presenters

Paper sessions are 90 minutes. Presentations should last no more than 20 minutes, including time for questions (unless arrangements are made in advance with the moderator). Moderators will arrange for a laptop to be present, but presenters are encouraged to bring their own laptops in case of technical issues. It is your responsibility to ensure that your session moderator has your slides before the session begins. You are encouraged to arrive to your session ten to fifteen minutes in advance.

Information for moderators

Your primary responsibility is to facilitate presentations. The moderator is responsible for keeping presentations to the allotted time and to encourage questions to facilitate a discussion after each presentation. Please bring a laptop and ensure that the slides for each presentation are loaded and prepared in advance. You are encouraged to arrive to your session ten to fifteen minutes in advance.

pour entrer. La réception aura lieu dans le Grand Ballroom.

Petit-déjeuner et déjeuner

Le petit-déjeuner et le déjeuner du lundi et du mardi sont inclus dans les frais d'inscription. Vous devez porter votre badge nominatif pour entrer. Le petit-déjeuner et le déjeuner seront servis dans le Grand Ballroom.

Informations pour les présentateurs

Les sessions de présentation durent 90 minutes. Les présentations ne doivent pas dépasser 20 minutes, y compris le temps pour les questions (sauf arrangement préalable avec le modérateur). Les modérateurs organiseront la présence d'un ordinateur portable, mais les présentateurs sont encouragés à apporter le leur en cas de problème technique. Il est de votre responsabilité de vous assurer que votre modérateur de session dispose de vos diapositives avant le début de la session. Vous êtes encouragés à arriver à votre session dix à quinze minutes à l'avance.

Informations pour les modérateurs

Votre responsabilité principale est de faciliter les présentations. Le modérateur est responsable de maintenir les présentations dans le temps imparti et d'encourager les questions pour faciliter une discussion après chaque présentation. Veuillez apporter un ordinateur portable et vous assurer que les diapositives de chaque présentation sont chargées et préparées à l'avance. Vous êtes encouragés à arriver à votre session dix à quinze minutes à l'avance.



SCHEDULE | HORAIRE

SUNDAY | DIMANCHE

July 7 juillet

4:30 PM - 8:00 PM	Registration Inscription
5:45 PM - 6:30 PM	Presidential Address Discours présidentiel
6:30 PM - 8:30 PM	Welcome Reception Réception de bienvenue

MONDAY | LUNDI

July 8 juillet

8:00 AM - 5:00 PM	Registration Inscription
8:00 AM - 9:00 AM	Breakfast Petit déjeuner
9:00 AM - 10:00 AM	Fellows Address Discours des fellows
10:00 AM - 10:30 AM	Break Pause
10:30 AM - 12:00 PM	Concurrent Sessions and Organized Symposia Sessions simultanées et symposiums organisés
12:00 PM - 1:30 PM	Lunch Déjeuner
1:30 PM - 3:00 PM	Concurrent Sessions Sessions simultanées
3:00 PM - 3:30 PM	Break Pause
3:30 PM - 5:00 PM	Concurrent Sessions Sessions simultanées
5:00 PM - 5:15 PM	Break Pause
5:15 PM - 6:30 PM	Annual Business Meeting Réunion d'affaires annuelle
7:00 PM - 9:00 PM	Awards Banquet Banquet de remise des prix

TUESDAY | MARDI

July 9 juillet

8:00 AM - 12:00 PM	Registration Inscription
8:00 AM - 9:00 AM	Breakfast Petit déjeuner
9:00 AM - 10:00 AM	Keynote Speaker Conférencier principal
10:00 AM - 10:30 AM	Break Pause
10:30 AM - 12:00 PM	Concurrent Sessions and Organized Symposia Sessions simultanées et symposiums organisés
12:00 PM - 1:30 PM	Lunch Déjeuner
1:30 PM - 3:00 PM	Concurrent Sessions Sessions simultanées
3:00 PM - 3:30 PM	Post Conference Coffee and Tea Café et thé de clôture



DETAILED PROGRAM | PROGRAMME DÉTAILLÉ

SUNDAY | DIMANCHE

July 7 juillet

Presidential Address | Discours présidentiel

5:45 PM - 6:30 PM Grand Ballroom

Nutritional inequality and the role of food policies in promoting healthy eating

Yu Na Lee, University of Guelph

Recently, there has been growing concern about income inequality globally. At the same time, there has been growing interest among researchers in understanding its implications for food consumption and health outcomes. This address focuses on nutritional inequality, specifically addressing the longstanding question of why certain sociodemographic groups, such as individuals with higher incomes, eat healthier than others. I first explore the income-nutrition-health nexus by gathering evidence from the literature. Next, potential drivers of nutritional inequality are discussed, focusing on supply-side and demand-side factors related to food. Then, I review the role of food and nutrition policies designed to enhance healthy eating, focusing on their distributional effects and drawing on studies conducted in Canada, the US, and other countries. Finally, I conclude with a future research agenda in this area.

Welcome Reception | Réception de bienvenue

6:30 PM - 8:30 PM Grand Ballroom

MONDAY | LUNDI

July 8 juillet

Breakfast | Petit déjeuner

8:00 AM - 9:00 AM Grand Ballroom



Fellows Address | Discours des fellows

9:00 AM - 10:00 AM Grand Ballroom

An Overview of Demand Analysis in Canada: What We Need to Know Going Forward and How We Will Achieve It

Ellen Goddard, University of Alberta

Economic analysis of food demand and how it changes over time is actually important to public policy related to agriculture, health and equity in our society. Traditionally we used publicly accessible data across time of per capita consumption of individual foods and looked at a range of goods establishing price and cross elasticities, income elasticities (anyone remember Hassan, Z. and S.R. Johnson (1976) “Consumer demand for major foods in Canada.” Ottawa, Ontario: Economics Branch, Agriculture Canada, or the more recent Pomboza, R., & Mbagu, M. D. (2007) “The estimation of food demand elasticities in Canada”). I, for example, historically, looked at food demand elasticities to try and predict market outcomes if sectors without supply management (beef, apples) instituted a supply management system within the country. We had fun and in those days tried to push the envelope on functional form. Recently the focus is more on looking at goods with credence attributes and trying to value those attributes. By definition, different tools provide different outcomes and the question remains open as to whether we can produce the economic measures of food demand that will be useful in terms of the range of public policies today. A lot has changed in terms of publicly-accessible data and the costs of examining food demand at a very granular level remain exorbitant for researchers. After reviewing what has and is being done I will also assess what will be needed in the future and how we can create or access the data needed to analyze food demand in Canada.

Break | Pause

10:00 AM - 10:30 AM

Concurrent Sessions and Organized Symposia | Sessions simultanées et symposiums organisés

10:30 AM - 12:00 PM

Organized Symposium 1: Applications of input output models on agri-food system: Analytical works from Canada, United States and Mexico

Grand Ballroom

Organizers: Deepananda Herath, Agriculture and Agri-Food Canada; Jill Smilestone, Agriculture and Agri-Food Canada; Laura Stortz, Agriculture and Agri-Food Canada; Solomon Aklilu, Agriculture and Agri-Food Canada; and Guangzhi (Flora) Cai, Agriculture and Agri-Food Canada



Chair: Deepananda Herath, Agriculture and Agri-Food Canada

Environmental Input-Output (EIO) Models for Food Systems Research

Sarah Rehkamp, US Department of Agriculture - Economic Research Service

Using the ERS-USDA Food-Dollar Method to Assess the Food Value Chain in Mexico

Araceli Ortega Díaz, EQUIDE-Universidad Iberoamericana

Assessing the Macroeconomic Impact of COVID-19 on the Canadian Agri-Food Industry

Xavier Bouchard-Vachon, Statistics Canada

Comparison of Food dollar series of Canada, United States and Mexico and potential policy implications

Deepananda Herath, Agriculture and Agri-Food Canada

Selected Paper Session 1: Risk in Agriculture

Selkirk Ballroom

Moderator: Rakhal C Sarker, University of Guelph

Electoral consequences of support for supply management: Quantifying political risk

Ryan Cardwell, University of Manitoba; Chad Lawley, University of Manitoba*

Did Farm Support Payments Induce Risk Balancing Behaviour in Ontario Grain and Oilseed Sector?

Rakhal C Sarker, University of Guelph*

How Crop Insurance Affects Producers' Crop Rotation Decisions in Saskatchewan

Warren Seib, University of Saskatchewan*

Drought and the Specialty Crop Production in California

Qingyin Cai, University of Minnesota; Metin Çakır, University of Minnesota; Timothy Beatty, University of California, Davis; Timothy A Park, US Department of Agriculture - Economic Research Service*

Selected Paper Session 2: Consumer and Public Preferences

La Verendrye Room

Moderator: Xiaoli Fan, University of Alberta

The Impact of Loyalty Points on Canadians' Preference for Low Sodium Bread

Mariam Abu-El-Magd, University of Guelph; Mike von Massow, University of Guelph; Yu Na Lee, University of Guelph*



Consumer Preference and Willingness to Pay for Beef Raised Under Different Antimicrobial Use Practices

*Michael O Olufemi**, University of Alberta; *Xiaoli Fan*, University of Alberta; *Henry An*, University of Alberta; *Simon Otto*, University of Alberta

Consumer willingness to pay for gene editing and reduced methane beef

Yury Simons, McGill University; *Mary Doidge**, McGill

Public Demand for Hemp Plastics as a Sustainable Single-Use Packaging Solution in Canada

*Abigail Danso Boahemaa**, University of Alberta; *Ellen Goddard*, University of Alberta

Selected Paper Session 3: Agricultural Production Decisions in Developing Countries

Gateway/Tache Room

Moderator: Nicholas Tyack, University of Saskatchewan

Gender perspectives of farmer-led irrigation in the Upper East Region of Ghana

*Mercy Apuswin Abarike**, University of Saskatchewan/University for Development studies; *Sabine SL Liebenehm*, University of Saskatchewan; *Margaret Akuriba*, University for Development Studies; *Alirah Weyori*, World Food Programme

Does a Lemon Technology for Pest Control Act as a Substitute for Insecticides

*Abubakr Ayesh**, University of Victoria; *Scott Swinton*, Michigan State University

Farmer uncertainty and demand for varietal identity information: DNA fingerprinting of smallholder rice seed in Côte d'Ivoire

*Nicholas Tyack**, University of Saskatchewan; *Aminou Arouna*, AfricaRice; *Nana Amoah*, AfricaRice; *Rachidi Aboudou*, AfricaRice

Lunch | Déjeuner

12:00 PM - 1:30 PM Grand Ballroom

Concurrent Sessions | Sessions simultanées

1:30 PM - 3:00 PM

Graduate Student Paper Competition

Selkirk Ballroom

Judges: Mary Doidge, McGill University; Alfons Weersink, University of Guelph; Xiaoli Fan, University of Alberta



E-commerce Resilience in Canada's agri-food Trade Amidst COVID-19

*Promesse Essolema**, University of Guelph; *Sylvanus Kwaku Afesorgbor*, University of Guelph; *Andreas Boecker*, University of Guelph

Crop theft, agricultural decisions, and outcomes: theory and evidence from Madagascar

*Olurotimi Soneye**, University of Guelph

Strategic Under-Reporting of Arsenic by Community Water Systems

*Jamie Naylor**, University of Guelph; *Brady Deaton*, University of Guelph

Selected Paper Session 4: Environmental and Resource Economics

Grand Ballroom

Moderator: Sébastien Box-Couillard, University of Illinois at Urbana-Champaign

The (not so) Simple Economics of Electric Vehicles

*Rebecca Zanello**, University of Victoria

Are Canadians willing to fund carbon capture and storage? Finding the balance between climate benefits and deployment costs

*Nimanthika Lokuge**, University of Alberta; *Sven Anders*, University of Alberta; *Mirko van der Baan*, University of Alberta

Racial Housing Discrimination and Flood Risk

*Sébastien Box-Couillard**, University of Illinois at Urbana-Champaign

Selected Paper Session 5: Farmer Adoption of Technologies

La Verendrye Room

Moderator: Albert Boaitey, Newcastle University

An experimental study on the role of risk and ambiguity in farmer adoption of conservation practices

*Jiaying Song**, McGill University; *Aurelie Harou*, McGill University; *Mary Doidge*, McGill University

Dairy and Beef Cattle Farmers and The Environment: Trait Preferences, Attitudes and Policy Perspectives

*Albert Boaitey**, Newcastle University; *Ellen Goddard*, University of Alberta; *Getu Hailu*, University of Guelph

Assessing Determinants of Agricultural Beneficial Management Practices Adoption: Evidence from the Survey on Local Food and Beneficial Management Practices

*Xavier Bouchard-Vachon**, Statistics Canada; *Simon Dessureault*, Statistics Canada



Genomic Trait Selection Adoption and Impact in the Canadian Dairy Industry: A Study of Producers' Perspectives

*Most Moriom Khatun**, University of Alberta; *Ellen Goddard*, University of Alberta

Selected Paper Session 6: Climate Change and Sustainability

Gateway/Tache Room

Moderator: Tristan Skolrud, University of Saskatchewan

Decarbonizing the Farm A Road Map for Saskatchewan Grain Farms to 2050

*Cecil N Nagy**, *Nagy Consulting*

Saskatchewan case studies in regenerative agriculture

*Claire A Owen**, *University of Saskatchewan*; *Tristan Skolrud*, *University of Saskatchewan*

Agriculture in the Face of Climate Change: Unraveling Economic Effects in Saskatchewan, Canada

*Nazila Mohtashami**, *University of Saskatchewan*; *Tristan Skolrud*, *University of Saskatchewan*

RICE Model with Afforestation

*Rebecca Zanella**, *University of Saskatchewan*; *Gerrit Cornelis van Kooten*, *University of Victoria*

Break | Pause

3:00 PM - 3:30 PM

Concurrent Sessions | Sessions simultanées

3:30 PM - 5:00 PM

Selected Paper Session 7: Environmental Impacts of Fertilizer

Gateway/Tache Room

Moderator: Obed Sappor, University of Guelph

The Economic and Environmental Impact of Nitrogen Inhibitors in Corn Production: A Study in Ontario.

*Obed T Sappor**, *University of Guelph*; *Aaron V De Laporte*, *University of Guelph*;
Alfons Weersink, *University of Guelph*



Simulation Modeling for Optimal Nitrous Oxide Emission Reduction Policies in Canola Production

*Shiva Naserabadi**, University of Saskatchewan; *Tristan Skolrud*, University of Saskatchewan

Assessing The Long-Term Profitability of Nitrogen Fertilization Rate Strategies

*Roy Ahiati**, University of Guelph; *Aaron V De Laporte*, University of Guelph; *Alfons Weersink*, University of Guelph

Selected Paper Session 8: Labour and Supply Chain Issues

La Verendrye Room

Moderator: José Nuño-Ledesma, University of Guelph

City-size and assortative matching in the Mexican formal labor market

*Jose Nuno-Ledesma**, University of Guelph; *Jorge Pérez Pérez*, Banco de México; *Jorge Meléndez Flores*, Banco de México

Labor replacing innovations versus skill-biased innovations: Evidence from food processing innovations in Canada

*Deepananda Herath**, Agriculture and Agri-Food Canada

The Effects of Vertical Integration on Mixed Duopoly

*Jamie Naylor**, University of Guelph; *Asha Sadanand*, University of Guelph

Empirical Evaluation of Learning Outcome Achievements by Mode of Instruction: Method and Application

*Janelle Mann**, University of Manitoba; *Abdul-Razak Yussif*, University of Manitoba

Selected Paper Session 9: Recreation and Agritourism

Grand Ballroom

Moderator: Qin Xu, University of Alberta

Assessing the Impact of State-Level Policy Incentives for Agritourism

Renata Endres, University of Illinois at Urbana-Champaign; *Suiwen Zou*, University of Illinois at Urbana-Champaign; *A. Bryan Endres*, University of Illinois at Urbana-Champaign; *Min-Fang Wei**, University of Toronto

Measuring the impact of a wildlife disease on hunting behaviour through recreational lottery applications: The case of Chronic Wasting Disease in Alberta

*Qin Xu**, University of Alberta; *Wiktoria Adamowicz*, University of Alberta; *Marty Luckert*, University of Alberta; *John Pattison-Williams*, University of Alberta; *Maria Dobbin*, University of Alberta; *Anne Hubbs*, Government of Alberta; *Margo Pybus*, Government of Alberta; *Evelyn Merrill*, University of Alberta



Food-related Motivations in Commitment to Hunting in Alberta

*Sandra Bondzewaa Odame**, *University of Alberta*; *Sven Anders*, *University of Alberta*;
Wendy Wismer, *University of Alberta*

Break | Pause

5:00 PM - 5:15 PM

Annual Business Meeting | Réunion d'affaires annuelle

5:15 PM - 6:30 PM Grand Ballroom

Awards Banquet | Banquet de remise des prix

7:00 PM - 9:00 PM Grand Ballroom

TUESDAY | MARDI

July 9 juillet

Breakfast | Petit déjeuner

8:00 AM - 9:00 AM Grand Ballroom

Keynote Speaker | Conférencier principal

9:00 AM - 10:00 AM Grand Ballroom

Artificial Intelligence-Based Digital Technologies for Sustainable Agriculture

Madhu Khanna, University of Illinois

Rapid advances and diffusion of artificial intelligence (AI) technologies has the potential to transform agriculture globally by improving measurement, prediction and site-specific management on the farm, enabling autonomous equipment that is trained to mimic human behavior and developing recommendation systems designed to autonomously achieve various tasks. This talk will describe the applications of AI-enabled technologies in agriculture and various ways through which AI driven technologies are likely to change the decision space for farmers and require changes to the theoretical and empirical economic models that seek to understand the incentives for their adoption.

Break | Pause

10:00 AM - 10:30 AM



Concurrent Sessions and Organized Symposia | Sessions simultanées et symposiums organisés

10:30 AM - 12:00 PM

Organized Symposium 2: Innovative Policy Approaches to Encourage BMP Adoption

Grand Ballroom

Organizer: Bruce Phillips

Experimental evidence on the role of risk and ambiguity on BMP adoption
Mary Doidge, McGill University

Economic Considerations, KTT and Extension Strategies for BMP Implementation
Marina Puzyreva, International Institute for Sustainable Development

The role of agricultural support programs on GHG reducing farming practices
Alfons Weersink, University of Guelph

Forestry and the Carbon Offset Conundrum
Rebecca Zanello, University of Saskatchewan

Selected Paper Session 10: Productivity and Efficiency Analysis

Selkirk Ballroom

Moderator: Bruno Wichmann, University of Alberta

Impact of Climate Change on Productivity and Technical Efficiency in Canadian Crop Production
Viktoriya Galushko, University of Regina*

Technical Efficiency of Wildfire Detection and Machine Learning Predictions in Alberta
Bruno Wichmann, University of Alberta*

Estimating Carbon Footprint and Environmentally Adjusted Total Factor Productivity of Alberta Dairy Farms
Bibek Dahal, University of Guelph; Getu Hailu, University of Guelph*

Selected Paper Session 11: Agricultural Trade

La Verendrye Room

Moderator: Joseph P Janzen, University of Illinois Urbana-Champaign



Who is the smart money in the market for US agricultural commodity exports?

*Joseph P Janzen**, University of Illinois Urbana-Champaign; *Massab Qayum*, University of Illinois Urbana-Champaign

A product-sectoral level analysis of COVID-19's impact on Canada's agri-food exports: Did FTAs mitigate this impact?

*Esther O Metieh**, University of Guelph; *Sylvanus Kwaku Afesorgbor*, University of Guelph; *Andreas Boecker*, University of Guelph

Ukraine's agricultural exports during war: insights into the Black Sea grain trade

Vitaliia Mishchenko, State Biotechnological University, Kharkiv; *Nicholas Tyack**, University of Saskatchewan

Revealed Comparative Advantage of Canola Seed Exports from Canada to Major Destinations

*Rakhal C Sarker**, University of Guelph; *Vivian Tran*, University of Guelph

Selected Paper Session 12: Household and Communities

Gateway/Tache Room

Moderator: Marc F. Bellemare, University of Minnesota

Commodity Prices and Mortality

*Marc F. Bellemare**, University of Minnesota; *Joleen Hadrich*, University of Minnesota; *Jih-Yun Liu*, University of Minnesota

Determinants of Food Security in the Northwest Territories, Canada

*Oscar Tetteh**, University of Saskatchewan; *Sabine SL Liebenehm*, University of Saskatchewan

What predicts permanent full-time job holder being food insecure?

*Min-Fang Wei**, University of Toronto; *Valerie Tarasuk*, University of Toronto

Contraband Tobacco in Canada: Market Processes, Incentives and First Nations Communities

*Danny G LeRoy**, University of Lethbridge; *Joseph Quesnel*, Frontier Centre for Public Policy

Lunch | Déjeuner

12:00 PM - 1:30 PM Grand Ballroom

Concurrent Sessions | Sessions simultanées

1:30 PM - 3:00 PM



Focus on Fellows: Volatility in Agricultural Markets: Ghosts of the Past, Present, and Future

Grand Ballroom

The session addresses volatility in agricultural markets from various perspectives. The session begins with a historical perspective on how Canada's supply management system for eggs emerged as a policy response to volatility (William Kerr, University of Saskatchewan). The second presentation provides a spatial time series analysis of western Canadian commodity price volatility in the context of climate change-induced price shocks and intra-regional spillovers (James Vercaemmen, University of British Columbia). The third presentation discusses the future of publicly subsidized crop insurance programs in Canada, debunking common myths about the impending insolvency of publicly subsidized crop insurance programs due to climate change (Alan Ker, Michigan State University).

Chair: Jill E. Hobbs, Professor, Department of Agricultural and Resource Economics, University of Saskatchewan

Disequilibrium and Volatility in the Canadian Egg Market – The Path to Supply Management
William A. Kerr, Distinguished Professor Emeritus, Department of Agricultural and Resource Economics, University of Saskatchewan

A Spatial Time Series Analysis of Western Canadian Commodity Price Volatility
James Vercaemmen, Professor, Food and Resource Economics, University of British Columbia

Climate Change and the Future of Publicly Subsidized Crop Insurance in Canada
Alan Ker, Professor and Elton R. Smith Chair in Food and Agricultural Policy, Department of Agricultural, Food, and Resource Economics, Michigan State University

Selected Paper Session 13: Commodity Prices

La Verendrye Room

Moderator: Alankrita Goswami, University of Manitoba

Market Linkages Between Canadian Wheat and US Energy and Agricultural Commodities
Curtis McKnight, University of Alberta; Feng Qiu, University of Alberta; Grant Hauer, University of Alberta; Marty Luckert, University of Alberta*

Order Flow Dynamics in Microstructure of Agricultural Futures Markets
Alankrita Goswami, University of Manitoba; Julieta Frank, University of Manitoba; Mehdi Arzandeh, Lakehead University; Justin Daniels, University of Manitoba*



Does the Futures or Cash Market Drive Price Discovery for Canadian Cattle?

Jared Carlberg, University of Manitoba; Zheting Zhu, University of Manitoba*

Order Aggressiveness in Agricultural Futures Markets

Zheting Zhu, University of Manitoba; Julieta Frank, University of Manitoba; Mehdi Arzandeh, Lakehead University; Alankrita Goswami, University of Manitoba; Justin Daniels, University of Manitoba*

Farm share of the food dollar in Canada: What the recent data shows us?

Jill Smilestone, Agriculture and Agri-Food Canada; Guangzhi (Flora) Cai, Agriculture and Agri-Food Canada; Laura Stortz, Agriculture and Agri-Food Canada; Solomon Aklilu, Agriculture and Agri-Food Canada; Deepananda Herath, Agriculture and Agri-Food Canada*

Selected Paper Session 14: Development

Gateway/Tache Room

Moderator: Liam D Kelly, University of Northern British Columbia

Industrial Policy, Economic Development, and Land Use Change: Evidence from the Caracol Industrial Park in Northern Haiti

Liam D Kelly, University of Northern British Columbia; Juan Ramirez Delgado, University of Northern British Columbia*

Impact of cash transfers on household food security during the lean season in Malawi

Anissa Collishaw, University of Illinois at Urbana-Champaign*

Agricultural Mechanization and Structural Transformation

Ling Yao, University of Minnesota*

Optimistic Entrepreneurs: Agri-dealer Exit and Consumer Impacts in Tanzania

Alix Naugler, Cornell University; Sarah Janzen, University of Illinois; Hope Michelson, University of Illinois*

Post Conference Coffee and Tea | Café et thé de clôture

3:00 PM - 3:30 PM



MADHU KHANNA BIOGRAPHY | BIOGRAPHIE



Dr. Madhu Khanna is the ACES Distinguished Professor of Environmental Economics in the Department of Agricultural and Consumer Economics and Alvin H. Baum Family Chair and Director of the Institute for Sustainability, Energy, and Environment, at the University of Illinois at Urbana-Champaign. She received her Ph.D. from the University of California at Berkeley. Her research is at the intersection of agricultural, energy and environmental economics and includes analysis of the land use and environmental effects of bioenergy, the economic and environmental implications of climate smart agriculture and digital farming practices and effectiveness of voluntary approaches to environmental protection. Her research has led to more than 170 peer-reviewed publications that are widely cited. She has served on the USEPA Science Advisory Board for 10 years and as a Chair/member of review panels for NIFA, USEPA and NSF and as a member of USDOE Technical Advisory Committee. She has served on the editorial boards of several prestigious disciplinary and interdisciplinary journals and is currently on the editorial boards of the *Annual Review of Resource Economics*, *Australian Journal of Agricultural and Resource Economics*, and *GCB Bioenergy*. She has also served on the Board of Directors of the Agricultural and Applied Economics Association (AAEA) and the Association of Environmental and Resource Economists (AERE). She is a University of Illinois Scholar, a Stanford Woods Institute of Environment Leopold Leadership Fellow, AAEA Fellow and past President of the AAEA.

2025 ANNUAL MEETING | CONGRÈS ANNUEL 2025

The 2025 CAES Annual Meeting will be held jointly with the Canadian Economics Association (CEA) at L'Université du Québec à Montréal (UQAM) in Montréal, QC, on May 30-31st, 2025. See you all next year in Montréal!



FLOOR PLANS | PLANS D'ÉTAGE



MEZZANINE FLOOR

FLOOR PLAN

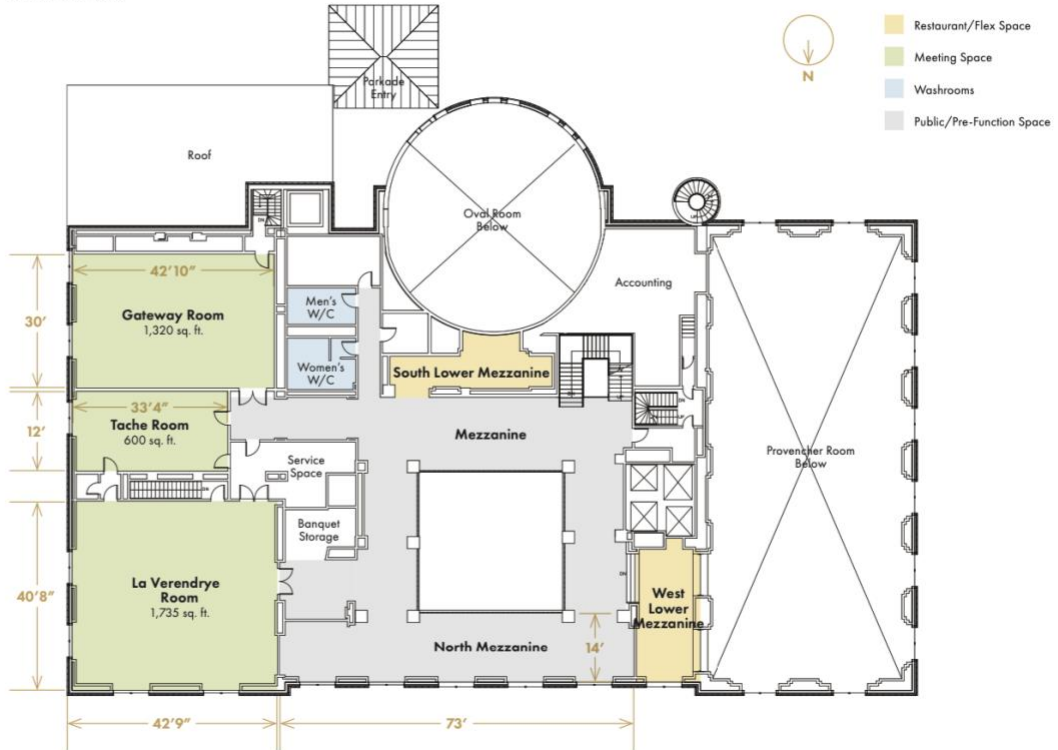



FORT GARRY PLACE

FLOOR PLAN



- Restaurant/Flex Space
- Meeting Space
- Washrooms
- Public/Pre-Function Space

